

Vinyl Insulated Spade Terminal

Drawn - SD

Approved - KM

Material - Copper / Vinyl Insulation

Title - Vinyl Insulated Spade Terminal

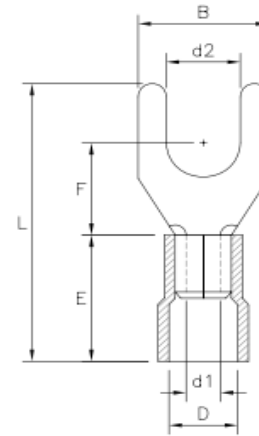

Part Number	Wire Range	Insulated Color	Electrical Rating Max	d1	d2	B	F	L	E	D
S22-4V	22-18 AWG	RED	75C / 300 Volts	0.066	0.125	0.228	0.248	0.826	0.393	0.161
S22-6V	22-18 AWG	RED	75C / 300 Volts	0.066	0.145	0.228	0.248	0.826	0.393	0.161
S22-8V	22-18 AWG	RED	75C / 300 Volts	0.066	0.169	0.283	0.248	0.826	0.393	0.161
S22-10V	22-18 AWG	RED	75C / 300 Volts	0.066	0.208	0.374	0.275	0.826	0.393	0.161
S22-14V	22-18 AWG	RED	75C / 300 Volts	0.066	0.255	0.472	0.433	1.07	0.393	0.161
S16-6V	16-14 AWG	BLUE	75C / 300 Volts	0.090	0.145	0.251	0.248	0.826	0.393	0.177
S16-8V	16-14 AWG	BLUE	75C / 300 Volts	0.090	0.169	0.283	0.255	0.834	0.393	0.177
S16-10V	16-14 AWG	BLUE	75C / 300 Volts	0.090	0.208	0.334	0.287	0.866	0.393	0.177
S16-14V	16-14 AWG	BLUE	75C / 300 Volts	0.090	0.255	0.472	0.433	1.070	0.393	0.177
S12-6V	12-10 AWG	YELLOW	75C / 300 Volts	0.133	0.145	0.334	0.295	0.992	0.492	0.255
S12-8V	12-10 AWG	YELLOW	75C / 300 Volts	0.133	0.169	0.374	0.295	0.992	0.492	0.255
S12-10V	12-10 AWG	YELLOW	75C / 300 Volts	0.133	0.208	0.374	0.295	0.992	0.492	0.255
S12-14V	12-10 AWG	YELLOW	75C / 300 Volts	0.133	0.255	0.472	0.472	1.228	0.492	0.255