

FEATURES:

1. MANUFACTURED FROM HIGH STRENGTH ELECTROLYTIC COPPER.
2. APPLICATION INCLUDE COPPER TAPPING, SPLICING/PIG TAILING.
3. COMPACT SIZE ALLOWS FOR EASY TAPING AND INSULATION OF CONNECTION.
4. COLOR CODE FOR PROPER CRIMP DIE SELECTION.
5. LOW INSTALLATION COST.
6. RANGE TAKING CONNECTORS ALLOWS FOR LOW INVENTORY REQUIREMENT.
7. ALLOWS FOR 2 CONTINUOUS PARALLEL CONDUCTORS.
8. TEMPERATURE AND VOLTAGE RATING: 90C, 600V

Copper Compression C-Tap CT-Series

Catalog Number	Copper Conduction Size		MIN. # OF CRIMPS REQUIRED	COPPER COLOR CODE	NSI DIE CODE	NSI TOOL	STD.CTN.QTY	DIMENSIONS			
	Main (Run)	Tap (Branch)						L	W1	W2	H
CTH-111	1	1	2	BLUE	KC12-250	N1240	25	0.787	0.629	0.787	1.29
	1/0	1/0-2									
	2/0	2/0-4									
	3/0	1/0-6									
	4/0	1-8									
CTH-112	2/0	2/0-1	2	BROWN	KC12-400	N1240	25	0.782	0.787	0.885	1.45
	3/0	3/0-3									
	4/0	4/0-4									
	250	1/0-8									
CTH-113	2/0	2/0-1	2	PINK	KC12-400	N1240	12	1.03	.824	0.984	1.67
	3/0	3/0-2									
	4/0	4/0-4									
	250	3/0-6									
	300	2/0-8									
CTH-114	4/0	4/0-2/0	2	BLACK	KC12-500	N1240	6	1.03	0.897	1.04	1.71
	250	250-1									
	300	4/0-4									
	350	3/0-6									
CTH-115	250	250	2	YELLOW	KC12-750	N1240	6	1.27	0.897	1.04	1.71
	300	300-3/0									
	350	350-1/0									
	400	300-2									
	450	250-4									
CTH-116	350	350-4/0	2	WHITE	KC12-750	N1240	3	0.787	0.629	0.787	1.29
	400	400-2/0									
	450	450-1									
	500	500-2									
CTH-117	750-500	4/0-6	4	-	T&B 15603	T&B TBM-15	3	27.24	1.33	1.34	2.74
	750	750-4/0									

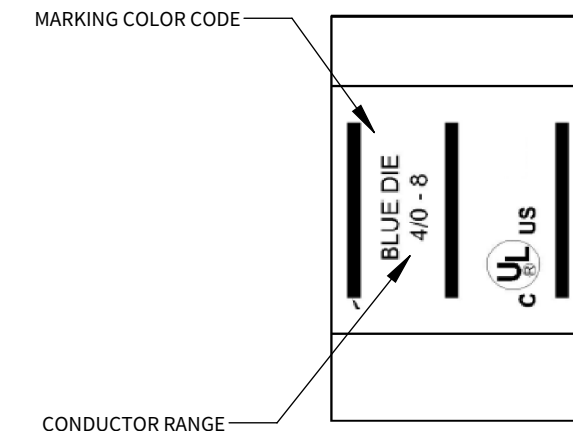
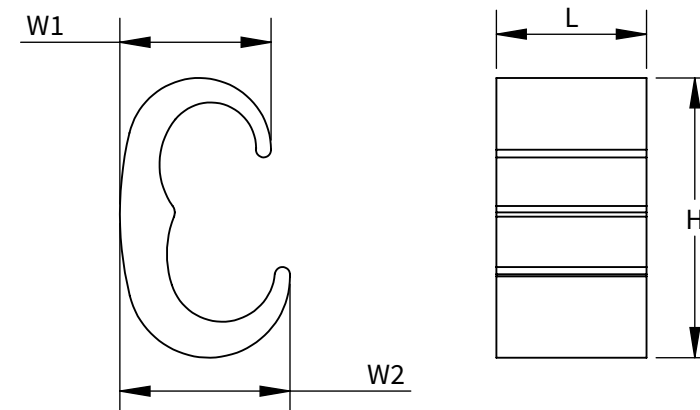

UL SPECIFICATIONS	<p>TO ORDER NSI PRODUCTS CALL CUSTOMER SERVICE DEPT @800-321-5847</p> <p>FOR NAME OF LOCAL SALES AGENT techteam@nsiindustries.com</p> <p>FOR PRODUCT INFO: www.nsiindustires.com</p>
UL486A LISTED WIRE CONNECTOR	
UL467 LISTED GROUNDING & BONDING	
CLASS B OR C BUILDING WIRE CU CABLE ONLY	