

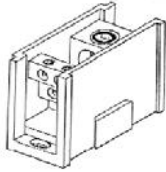

# Connector Bloks™



Drawn - SD  
Approved - KM

Title - Connector Bloks™

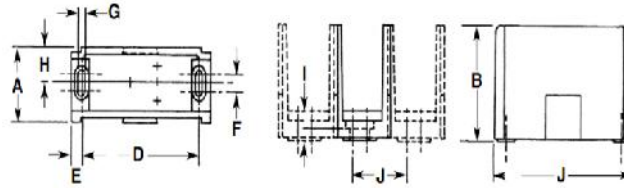

Dual Rated Connector Bloks

Insulator Cat. No	A	B	C	D	E	F	G	H	I	J	
S	1.04	2.34	2.90	2.25	0.18	0.35	0.20	0.46	0.19	0.63	1.25
M	1.71	2.62	4.00	3.50	0.25	0.37	0.20	0.79	0.20	1.25	1.87
L	2.90	3.25	5.50	5.00	0.25	0.50	0.27	1.38	0.29	2.25	3.25

Part Number	Temp Rating	Line Side	Load Side	Amps Per Pole	Insulator Block			Insulator Block Size
					L	W	H	
AS-K1-H4	90 C	 2/0-14 AWG	 4-14 AWG	175	2.90	1.04	2.34	S
AS-K1-H6	90 C	 2/0-14 AWG	 4-14 AWG	175	2.90	1.04	2.34	S
AM-P1-H6	90 C	 350MCM-6AWG	 4-14 AWG	310	4.00	1.71	2.62	M
AM-P1-H12	90 C	 350MCM-6AWG	 4-14 AWG	310	4.00	1.71	2.62	M
AM-R1-H12	90 C	 500MCM-4AWG	 4-14 AWG	380	4.00	1.71	2.62	M
AL-R1-M4	90 C	 500MCM-4AWG	 4/0-6 AWG	380	5.50	2.90	3.25	L
AL-P1-K6	90 C	 350MCM-6AWG	 2/0-14 AWG	310	5.50	2.90	3.25	L
AL-R1-K6	90 C	 500MCM-4AWG	 2/0-14 AWG	380	5.50	2.90	3.25	L
AL-V1-K6	90 C	 1000-250 MCM	 2/0-14 AWG	545	5.50	2.90	3.25	L