

Splicer Reducer

For splicing two copper or aluminum wires of equal or different sizes. Made of 6061T-6 aluminum alloy. Tin plated for low contact resistance with center stop, rated 600V.

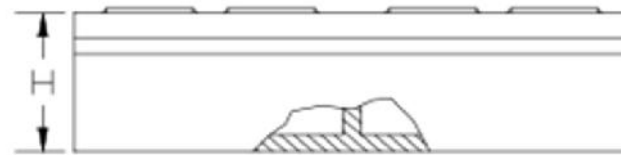
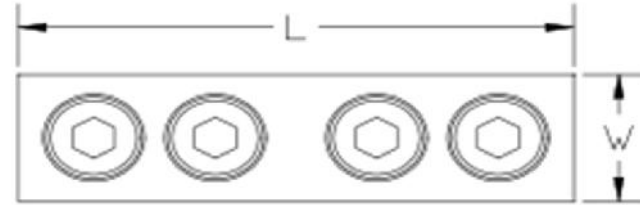

Drawn - SD

Approved - KM

Material - Aluminum

Title - Splicer Reducer



Part Number	Wire Range	Material	Bolt Shape	L	W	H
250SR	250 MCM-6 AWG	Aluminum	Allen	4.094	0.812	1.000